

FOUR STROKE
 INTAKE SYSTEMS
 ENGINE/GASKETS
 EXHAUST
 DRIVE LINE HANDLING
 ELECTRICAL
 WATERLINE /BILGE
 STEERING & CONTROLS
 BODY
 SERVICE TOOLS ACCESSORIES /HARDWARE
 CHEMICAL

Internal Identification Tag

Waterproof Dobby Nylon with 3 Layers of PVC Coating Underneath

Zippered Gas Flap Opening on Most Models

Fat Adjustable Shock Cords are Sewn in Full Length on of the Cover

Reinforced Nose Pin Openings

**2" Tie Downs with Buckles
 Sitdown PWC have 4 Tie Down Points
 Stand Up PWC have 3 Tie Down Points**

Upper/Lower Bow Area is Reinforced with PVC Abrasion Resistant Material



Tie Down end has a "Loop N Draw" System for a Tight Secure Fit

SEA DOO	Part No.
RXP (05-07), RXP-X (08-09)	SDO03010
GTX-LTD (04-08), GTX DI (02-03), GTX-4-TEC Supercharged (03-06), RXT (05-09), RXT-X (08-09), GTX 4-TEC (02-06), GTX WAKE (04-09), GTX (07-08), GTX LTD. (07-08), GTX WAKE (07-08), GTX WAKE 155 & 215 (08)	SDO03018

YAMAHA	Part No.
Superjet 700	YMH04003
FX-HO (06-09), FX-HO Cruiser (06-09)	YMH04019
FX SHO (08-09), FX SHO Cruiser (08-09)	
VX 110 Deluxe & Standard (05-09)	YMH04020
VX Sport (09), VX (09) Non Cruiser	
GP1200R (00-02), GP1300R (03-08), GP800R (01-05)	YMH04001

KAWASAKI	Part No.
800 SX-R (03-09)	KWS05006
STX-15F (04-09), STX 12-F (05-09), STX Base (09)	KWS05011
Ultra 250X/LX (07-09), Ultra 260X (09)	KWS05018
Ultra 260LX "Cruiser Seat" (09)	

Jettribe

Personal Watercraft Goggles - Eye Protection



100% UV Protection **Dual Layer Foam For Comfort** **Anti Fogging Air Vents** **They Float**

Description	Part No.
Goggles Red Frame with Smoke Lens	JA071301
Goggles Yellow Frame with Smoke Lens	JA071302
Goggles Blue Frame with Smoke Lens	JA071303
Goggles Black Frame with Amber Lens	JA071304
Goggles Black Frame with Smoke Lens	JA071305
Goggles Kids Black Frame with Smoke Lens	JA091302



GOGGLE GRIP

- Aligns riders preferred goggle strap positioning on helmet
- Prevents strap from shifting or slipping off helmet
- Lift and Hold feature secures goggles under visor between rides
- Simply pinch and lift strap for easy removal
- Low-profile, concave design matches curvature of helmet
- Transparent VHB™ Peel & Stick application with alcohol prep pad

Description	Color	Part No.
Goggle Grip	Clear	70-4040
Goggle Grip	Black	70-4041
Goggle Grip	Silver	70-4042
Goggle Grip	Chrome	70-4043

FOUR STROKE	INTAKE SYSTEMS	ENGINE/GASKETS	EXHAUST	DRIVE LINE HANDLING	ELECTRICAL	WATERLINE /BILGE	STEERING & CONTROLS	BODY	ACCESSORIES	SERVICE TOOLS /HARDWARE	CHEMICAL
-------------	----------------	----------------	---------	---------------------	------------	------------------	---------------------	------	-------------	-------------------------	----------



Atlantis NEW SPEC FLOATS

The quick and easy way to float your expensive glasses. These Atlantis Spec Floats have universal ends to fit all types of frames, from skinny to fat ones, just slide them on.

Description	Part No.	Description	Part No.
Purple	A2286	Black	A2287
Yellow	A2291	Red	A2292
Blue	A2282	Grey	A2280

BLUEYE eyewear



BLUEYE SQUID WATERSPORTS SUNGLASSES

- Frame is made from TR90 Grilamide
- Rubber touch finish to the frame
- Polycarbonate UVA & UVB lenses offer maximum protection
- Lenses finished with a hydrophobic watershield coating
- Each pair of Squid comes with a floating leash

Description	Part No.
Blueye Black Frame with Red Revo Smoke Lens	SQUID-RED

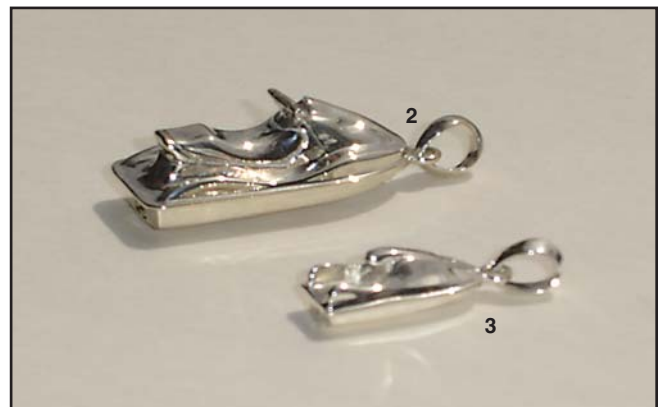

KAWASAKI PWC SILVER ACCESSORIES

Description	Part No.
1) SXR (Not shown above)	B-SA-SXR-BIG
2) STX-R	B-SA-STX-R
3) SX-R (small)	B-SA-SXR-SML

"929" Silver, Regular size 30mm, small size 18mm, chain is not included.

FOUR
STROKEINTAKE
SYSTEMSENGINE/
GASKETS

EXHAUST

DRIVE LINE
HANDLING

ELECTRICAL

WATERLINE
/BILGESTEERING
& CONTROLS

BODY

SERVICE TOOLS
ACCESSORIESSERVICE TOOLS
/HARDWARE

CHEMICAL



LEG DEFLECTOR

Made with polycarbonate.
Made in Italy

Description	Part No.
Leg Deflector	1002RACE-02

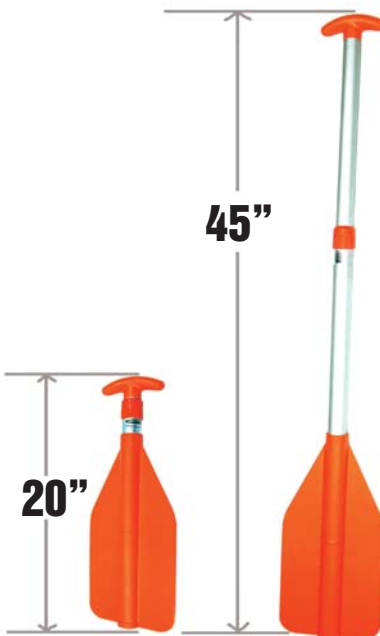

TELESCOPING PADDLES

Lightweight paddles adjust easily to variable lengths with a simple twist. A section of the aluminum shaft disappears inside the blade for the ultimate in compact storage under boat seats or in PWC storage compartments. 20-45 inch long.

Description	Part No.
Telescoping Paddle	P-1



LEG DEFLECTOR

Made in England

Description	Part No.
Leg Deflector	70-4012



DETACHABLE PADS

Constructed of soft foam with adhesive backed Velcro. Can be removed and re-applied by Velcro system. Pads for riding comfort.

Description	Part No.
Detachable Pad	1002PAD



HYDRO-TURF BACK SUPPORT

Great for racing, recreational riding or just working around the house! Light weight. Will not absorb water. Available in Black only.

Description	Part No.
Black S: 24-30	B20-BLK-S
Black M: 29-36	B20-BLK-M
Black L: 35-42	B20-BLK-L
Black XL: 41-48	B20-BLK-XL



RESCUE STREAMER DISTRESS SIGNAL

Patented Design Approved for U.S. Military & Coast Guard

This bright orange Streamer, visible from 1.3 miles away at 1,500 ft. altitude, leads Search and Rescue teams right to you. The patented high-strength polyethylene Streamer design, tested and used by the U.S. Military and Coast Guard, is marked with the international distress symbol. It features sealed air-filled struts that keep *RescueStreamer™* afloat on water and open on land to pinpoint your exact location to rescuers. *RescueStreamers™* start at the size of a cellular phone when stored and unroll in seconds! Always ready for use anywhere—land, water and snow. Does not require chemicals, batteries or electronics to signal continuously.

Description	Part No.
Rescue Streamer Distress Signal	RSDS-01





LIFESLED FOR PWC RESCUE

Lifeguards and public safety agencies around the world are embracing an innovative rescue system that already has saved hundreds of lives, and promises to save thousands more in extreme rough water situations such as ocean storms, heavy surf, rip currents, flooding rivers and other life-threatening situations.

Non-invasive hookup conveniently attaches LIFESLED to most any PWC without cumbersome rigging or drilling holes.



- ◆ LIFESLED is highly maneuverable. It barely affects low-speed motoring and increases the overall stability of the craft. There is no chance of windmilling or dumping of victim.
- ◆ Bullet-nose allows 45° fish-tail pivot off the PWC transom.
- ◆ 70/30 rails allow sufficient tracking for stability, and still allow the driver to 'break loose' for quick turns.
- ◆ Inexpensive, replaceable nose-guard protects the nose of the sled and the PWC transom.
- ◆ Overall size is sufficient for two adults yet still highly maneuverable. Weighs only 35 lbs.
- ◆ The Swallow-tail design enables easy victim centering when mounting in the water.
- ◆ Hook-up design allows the sled to be folded over the PWC when not in use.

Description	Part No.
Lifesled	W20018
<i>We do not carry inventory of these items—special order only.</i>	



HONDA



YAHAMA



SEA DOO



FOUR STROKE	INTAKE SYSTEMS	ENGINE/GASKETS	EXHAUST	DRIVE LINE HANDLING	ELECTRICAL	WATERLINE /BILGE	STEERING & CONTROLS	BODY	ACCESSORIES	SERVICE TOOLS /HARDWARE	CHEMICAL
-------------	----------------	----------------	---------	---------------------	------------	------------------	---------------------	------	-------------	-------------------------	----------

HOT PRODUCTS APPAREL & ACCESSORIES

FOUR STROKE
INTAKE SYSTEMS
ENGINE/GASKETS
EXHAUST
DRIVE LINE HANDLING
ELECTRICAL
WATERLINE /BILGE
STEERING & CONTROLS
BODY
SERVICE TOOLS ACCESSORIES /HARDWARE
CHEMICAL



Description	Part No.
Hot Products 25th Anniversary T-Shirt - X-Large	70-9025-XL
Hot Products 25th Anniversary T-Shirt - Large	70-9025-L
Hot Products 25th Anniversary T-Shirt - Medium	70-9025-M
Hot Products 25th Anniversary T-Shirt - Small	70-9025-S

HOT PRODUCTS 25TH ANNIVERSARY T-SHIRT



KNIGHT TEE ORANGE

Description	Part No.
Knight Tee - Medium	70-7090-M
Knight Tee - Large	70-7090-L
Knight Tee - XLarge	70-7090-XL
Knight Tee - Women	70-7090-WOMEN
Knight Tee - Kids Sm 6-8	70-7090-KIDS-S
Knight Tee - Kids Med 10-12	70-7090-KIDS-M

CHECKERED FLAG TEE

White



Description	Part No.
Checker Flag Tee - Medium	70-9008-M
Checker Flag Tee - Large	70-9008-L
Checker Flag Tee - XLarge	70-9008-XL
Checker Flag Sweatshirt	70-9011-XL

DEW DESIGN TEE

Green



Description	Part No.
Dew Design Tee - Medium	70-9087-M
Dew Design Tee - Large	70-9087-L
Dew Design Tee - XLarge	70-9087-XL
Dew Design Tee - 2XL	70-9087-2XL

SKULL TEE

Black



Description	Part No.
Skull Tee	70-9100-XL

HOT ESTABLISHED 1985 TEE

Grey



Description	Part No.
Est. 1985 Tee - Large	70-9088-L
Est. 1985 Tee - XLarge	70-9088-XL
Est. 1985 Tee - 2XL	70-9088-2XL
Est. 185 Sweatshirt - Large	70-9089-L
Est. 185 Sweatshirt - XLarge	70-9089-XL

APBA JUNIOR STAR TOUR SHIRT



Description	Part No.
APBA Jr Star Shirt - Small	70-7095-S
APBA Jr Star Shirt - Medium	70-7095-M
APBA Jr Star Shirt - Large	70-7095-L
APBA Jr Star Shirt - XLarge	70-7095-XL

MONKEY GRIP TEE

Tan



Description	Part No.
Monkey Grip Tee	70-9050-XL

HOT PRODUCTS DIE CUT DECALS



Die Cut Decal Size	White	Black	Die Cut Decal Size	White	Black
4" x 16"	70-9151	70-9152	3.5" x 12"	70-9132	70-9133
5" x 24"	70-9153	70-9154	6.5" x 23"	70-9136	70-9137

HOT PRODUCTS RACING IRON ON TRANSFER



Create your own custom apparel with this easy to use Hot Products Racing Iron on logo. 7 1/2" wide by 2" tall, in white only.

Description	Part No.
Iron On Transfer	LOGO-TRANSFER

HOT PRODUCTS RACING OUTDOOR/EVENT BANNER



Hot Products Racing Banner. 10' wide by 3' tall. Outdoor vinyl with grommets to hang the Banner up. The Banner is bright red with white lettering.

Description	Part No.
Hot Product Racing Banner	BANNER-ORANGE

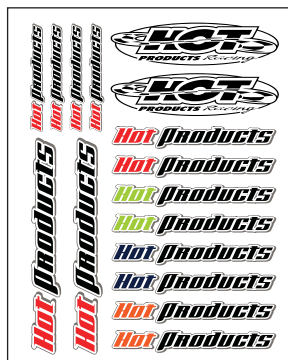

HOT PRODUCTS DECAL SHEET

Description	Part No.
Hot Products Decal Sheet 8" x 12 1/2"	70-9148



HOT PRODUCTS BEANIES

Description	Part No.
Hot Products Racing Beanies - Orange	70-9004-ORG
Hot Products Racing Beanies - Black	70-9004-BLK



Description	Part No.
AP Designs Box Tee Red	BT-004-L
AP Designs Box Tee Red	BT-004-XL
AP Designs Box Tee Yellow	BT-005-L
AP Designs Box Tee Yellow	BT-005-XL
AP Designs Box Tee Green	BT-006-L
AP Designs Box Tee Green	BT-006-XL
AP Designs Box Tee Blue	BT-007-L

Description	Part No.
Flame Dutch T White	FD-022-L
Flame Dutch T White	FD-022-XL
Flame Dutch T Black	FD-023-L
Flame Dutch T Black	FD-023-XL



Description	Part No.
Strip Ringer Steel	SRT-008-L
Strip Ringer Steel	SRT-008-XL
Strip Ringer Brown	SRT-009-L
Strip Ringer Brown	SRT-009-XL

Description	Part No.
Spike Hoodie Gray	SH-011-L
Spike Hoodie Gray	SH-011-XL
Spike Hoodie White	SH-012-L
Spike Hoodie White	SH-012-XL

FOUR STROKE	INTAKE SYSTEMS	ENGINE/ GASKETS	EXHAUST	DRIVE LINE HANDLING	ELECTRICAL	WATERLINE /BILGE	STEERING & CONTROLS	BODY	ACCESSORIES	SERVICE TOOLS /HARDWARE	CHEMICAL
----------------	-------------------	--------------------	---------	------------------------	------------	---------------------	------------------------	------	-------------	----------------------------	----------

Atlantis®

FOUR STROKE
INTAKE SYSTEMS
ENGINE/GASKETS
EXHAUST
DRIVE LINE HANDLING
ELECTRICAL
WATERLINE /BILGE
STEERING & CONTROLS
BODY
SERVICE TOOLS ACCESSORIES /HARDWARE
CHEMICAL



FLOATING WRIST LANYARDS

These old favorite lanyards have been redesigned so that they clip apart to be used as a wrist or a vest lanyard. They are the perfect lanyards to replace your factory one; they're made from polyurethane cord and they float. They come with our one hand easy slider.

Description	Black/ Black	Black/ Red	Purple/ Yellow	Yellow/ Purple	Black/ Silver	Black/ Blue	Green/ Purple
KPTW*	A2137	A2136	A2141	A2133	A2126	-	A2131
Yamaha	A8147	A8146	A8151	A8143	A8136	A8139	-
Sea Doo	A7467	A7466	A7471	A7463	A7480	-	-

*KPTW stands for: KAWASAKI, POLARIS, TIGERSHARK, WET JET

ULTRA VEST FLOATING LANYARDS

Our new improved standard lanyard now floats! Now an easy way to keep an extra lanyard close at hand.

Description	Black	Red	Yellow	Purple	Silver	Blue	Green
KPTW	A2109	A2103	A2097	A2106	A2096	A2107	A2101
Yamaha	A8130	A8123	A8133	A8128	A8134	A8129	-
Sea Doo	A7459	A7453	A7447	A7456	A7445	A7457	-

*KPTW stands for: KAWASAKI, POLARIS, TIGERSHARK, WET JET

SEA DOO DESS COMPATIBLE WRIST LANYARDS

Atlantis is proud to offer the only after market lanyards that are compatible with the Sea-Doo's DESS system. These lanyards fit all Sea-Doo watercrafts, Jet Boats, and Snowmobiles from 1996 to current (except '96 XP & GTI). Program with factory programmer.

Description	Black/Yellow	Purple/Yellow
Sea Doo DESS	A7473-DSC	A7471-UDC

SEA DOO DESS COMPATIBLE FLOATING LANYARDS

Description	Black	Red	Yellow
Sea Doo DESS	A7459-DES	A7453-DES	A7447-DES
Description	Purple	Silver	Blue
Sea Doo DESS	A7456-DES	A7445-DES	A7457-DES



PRO FLOATING WRIST LANYARDS

Our Pro floating lanyards have been used by the pros for years. They have been made of marine grade webbing, neoprene and Velcro material for strength, safety, and dependability. These lanyards will stay secure during the most strenuous riding, including racing. The whistle attaches and detached quickly.

Description	Black	Red	Yellow	Purple	Silver	Blue
KPTW	A2109-PFW	A2103-PFW	A2104-PFW	A2106-PFW	A2096-PFW	-
Yamaha	A8130-PFW	A8123-PFW	A8126-PFW	A8128-PFW	A8134-PFW	A8129-PFW
Sea Doo	A7459-PFW	A7453-PFW	A7447-PFW	A7456-PFW	A7445-PFW	-

*KPTW stands for: KAWASAKI, POLARIS, TIGERSHARK, WET JET





PRO FLOATING LANYARD WRIST BAND

Now available by itself, is our deluxe floating wristband made from marine grade webbing, neoprene, and Velcro. It attaches easily to any clip lanyard and gives the rider a sense of security he has been looking for.

Description	Black	Red	Yellow	Purple	Silver
Wristband	A2070	A2072	A2074	A2071	A2077



JET LOGIC SAFETY WHISTLE ON FLOATING LANYARD

An audible signal device is required on boats and personal watercraft in most states. A high pitch pealess whistle is a good choice. Clip it onto your life jacket or safety lanyard. Doubles as a floating key chain!

Description	Color	Part No.
Jet Logic Safety Whistle	Purple/Yellow	W-1
Jet Logic Safety Whistle	Red/Black	W-2



CLIP ON SAFETY WHISTLE

Description	Black	Red	Yellow	Purple
Clip On Whistle	A2700C	A2701C	A2706C	A2705C



PROWATERCRAFT LANYARD

This race inspired ProWATERcraft Lanyard, is a must have for all watercraft racers. The stock Yamaha lanyard has been the standard till now. ProWATERcraft Lanyard has a

thicker stronger red cord, a metal fastener for the life vest, and added functional finger grip when snapping it back in on the rush. You don't want to get caught off guard wearing anything else. Quality, durability and function is what the pro's use. Fits: All Kawasaki, Yamaha, Honda, Polaris, Tigershark, Hydrospace..... Not Sea Doo.

Description	Part No.
Pro Watercraft Lanyard (Available in Red only)	PWCL-06



JET LOGIC ULTIMATE PWC SAFETY LANYARDS

The Ultimate PWC safety lanyard has it all! 3 keys to fit ALL brands: Sea Doo, Yamaha, Kawasaki, Polaris, Tiger Shark and Wet Jet. *Excluding the Sea Doo DESS System.

Description	Part No.
Yellow/Purple	UL-1
Black/Red	UL-2
Blue/Silver	UL-3



SHOP LANYARDS

Not legal for riding. For shop testing only. These can easily be attached to your belt while working on all PWC and jet boats.

Description	Part No.
KPTW, Yamaha, Sea Doo	A3240
KPTW, Yamaha, Sea Doo DESS	A3250



ECONOMY WRIST LANYARDS

Economy price lanyards.
For Sea Doo (Non-DESS) only.

Description	Part No.
Sea Doo Wrist Lanyard Purple/Green	WJ7094PU
Sea Doo Wrist Lanyard Green/Purple	WJ7094GR
Sea Doo Wrist Lanyard Blue/Green	WJ7094B

FOUR STROKE	ENGINE/ GASKETS	EXHAUST	DRIVE LINE HANDLING	ELECTRICAL	WATERLINE /BILGE	STEERING & CONTROLS	BODY	ACCESSORIES	SERVICE TOOLS /HARDWARE	CHEMICAL
-------------	-----------------	---------	---------------------	------------	------------------	---------------------	------	-------------	-------------------------	----------

Atlantis®



ATLANTIS ANCHOR BAG

Our newly redesigned bag anchor is strong as ever but with bright new colors, rope, float, and hook. Just fill with rocks and sand for your anchoring needs. Fits easily into any storage compartment.

Description	Part No.
Anchor Bag (regular)	A2381



ATLANTIS STAKE ANCHOR

Needing an easy way to keep your personal watercraft tied to a shore? Here it is, just screw the stake into the ground and you have 15' to tether your boat to shore. Easy to store and take with you.

Description	Part No.
Stake Anchor	A2384



ATLANTIS NAVY ANCHOR W/BAG

This is the new hot set up for those needing an anchor without the hassles of carrying big heavy ones. Easily attaches to and anchors in any personal watercraft, comes with its own handy storage bag. This 2 1/2 lb. anchor is designed to be hand set.

Description	Part No.
Navy Anchor w/Bag	A2382



ATLANTIS LARGE ANCHOR BAG

This new bag is twice as large as our standard bag. It has sewn-in handles for ease in moving and emptying. Designed for 3 & 4 passenger PWC or mini-jet boats.

Description	Part No.
Large Anchor Bag	A2394



ATLANTIS DELUXE PWC SAND STAKE KIT

Need to anchor your PWC on a sandy beach. This is the way. Just screw it in and it is set. It will not pull out. Comes with cushioned travel bug.

Description	Part No.
Deluxe PWC Sand Stake Kit	A2391



ATLANTIS GALVANIZED 6 LB. ANCHOR KIT

The anchor will hold boats from 20' - 24'. It comes with the 4' of chain, 100' rope, shackle and a large storage bag all at a value price.

Description	Part No.
Galvanized 6 lbs Anchor	A2397



KWIK TEK COMPLETE FOLDING ANCHOR SYSTEM

3-1/3 Lb 4-fluke folding anchor and 25ft. long marine grade rope.

Description	Part No.
Complete Anchor System	A-2



KWIK TEK 20" DIAMETER BUOY

The affordable alternative! These durable 20" diameter inflatable buoys are perfect for marking anchors, moorings, hazards, swimming areas, or for setting up a personal watercraft or sailboat race course. They deflate quickly and easily for space efficient storage.

Description	Part No.
Yellow Buoy 20"	B-20Y
Red Buoy 20"	B-20R

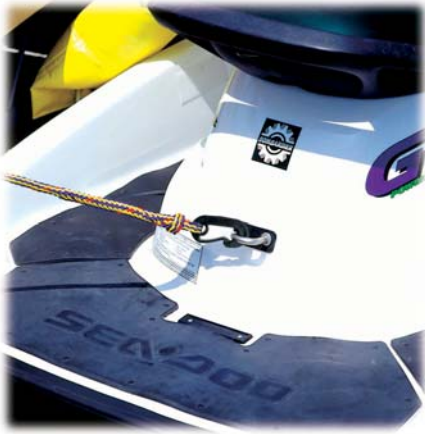

PWC DOCK LINE

There is a 10" loop on the other end for attaching to dock cleats. Finished length is 7 feet. 2 per clam shell package.

Description	Part No.
PWC Dock Line	PWCP-2



BUNGEE DOCK LINES

Airhead Bungee Dock Lines absorb shock to boats, cleats, pylons and other hardware. The bungee cord is hidden inside the rope and acts as a built-in snubber. Two foam floats protect the boat from chafing. 4 feet, stretches to 5-1/2 feet.

Description	Part No.
Bungee Dock Line	AHDL-4



GIANT SNAP HOOK

Perfect for attaching ski lines, dock lines, tow lines, or any rope up to 1/2 inch diameter.

Description	Part No.
Giant Snap Hook	SH-5



25' POLYPRO ROPE

The ideal extra rope to carry for any purpose: Docking, anchoring & towing. 1325 lbs. strength. Great to have in any situation.

Description	Part No.
White	A1960
Yellow	A1961
Red	A1962
Blue	A1963



3" X 5" ROPE FLOAT

Need a way to mark an area? Need to float a rope for docking? Here is your answer, our easy to use rope floats. Fits up to a 1/2" diameter rope.

Description	Part No.
Red/White	A-1974
Blue/White	A-1975
Yellow/White	A-1976



DRAWSTRING MESH BAG

Size 20" x 30"

Description	Part No.
Drawstring Mesh Bag	69-1003



SPARK PLUG HOLDERS

Spark Plug Holder protects the electrode, maintaining the proper gap.

Description	Part No.
2 per blister pack	SPH-2
40 per countertop display	SPH-40



DOC ALLEN'S VERSATOOL

The Swiss Army Knife of Hand Tools!

- Lightweight
- Compact
- Multi-Function
- Stainless Steel
- Use in Tight Places

Description	Part No.
Compact Tool Set	VERSATOOL

FOUR STROKE	INTAKE SYSTEMS	ENGINE/GASKETS	EXHAUST	DRIVE LINE HANDLING	ELECTRICAL	WATERLINE /BILGE	STEERING & CONTROLS	BODY	ACCESSORIES	SERVICE TOOLS /HARDWARE	CHEMICAL
-------------	----------------	----------------	---------	---------------------	------------	------------------	---------------------	------	-------------	-------------------------	----------

VIEWTAINER

Made in the U.S.A



Description	Part No.
2" x 6" Red	CC26-RED
2" x 6" Blue	CC26-BLU
2" x 6" Green	CC26-GRN
2" x 6" Orange	CC26-ONG
2" x 6" Yellow	CC26-YLW
2" x 6" Black	CC26-BLK

VIEWTAINER

Ideal to keep your registration papers safe & dry. They are great to carry small tools/supplies, etc.



Description	Part No.
2.75" x 8" Red	CC27508-RED
2.75" x 8" Blue	CC27508-BLU
2.75" x 8" Green	CC27508-GRN
2.75" x 8" Orange	CC27508-ONG
2.75" x 8" Yellow	CC27508-YLW
2.75" x 8" Black	CC27508-BLK



HYDRO-TURF DRY BOX

Keep your registration papers and small tools/supplies dry and safe. Actual product is black color only.

Description	Part No.
Dry Box 6" x 8.5"	BOX
Color is Black	



DRY PAK GPS/PDA GAMEBOY CASE

Convenient Stylus Holder
 • 5" wide x 8" long
 • maximum circumference = 9in.



DRY PAK MULTI-PURPOSE CASE

- 9" wide x 12" long
- 2 D-Rings sewn to corners
- Holds owner's manual, registration, snacks, maps, electronics



2008 WORLD FINALS • LAKE HAVASU, AZ
 PHOTO COURTESY OF JIN OMURA

Description	Part No.	Description	Part No.
GPS/PDA/Gameboy Dry Pak Case	DP-58	Dry Pak Case	DPC-912



WATERPROOF LINER

This durable and waterproof 19oz. vinyl dry bag with RF-welded seams, fits most PWD storage compartments. Fill it, roll down to fit the height of the storage compartment, then snap it shut. Locating packed items is easy with see-through material. Load it with beverages and ice and use it as a cooler! Size: 12" x 6" x 18".

Description	Part No.
Waterproof Liner Clear	SBL-1



"DRY PAK" DRY BAGS

Description	Part No.
9.5" Diam. x 16" Yellow	WB-1
11.5" Diam. x 19" Yellow	WB-4
12.5" Diam. x 28" Yellow	WB-7



HANDLEBAR PACK

Description	Part No.
Handlebar Pack	69-1002



HEAVY DUTY TUBE ROPE

This heavy tournament quality 3/8" 16-strand braided tow rope is rated at 2375 lbs. tensile strength for 1 and 2 riders. 60 feet.

Description	Part No.
Deluxe Tube Rope	AHTR-60



4000LB TUBE ROPE

This heavy duty 9/16" x 60ft. tube rope is rated at over 4375 lbs. tensile strength for 3 and 4 riders.

Description	Part No.
4000lb Tube Rope	AHTR-4000



6000LB TUBE ROPE

This super strength 16 strand, 7/8 inch x 60 foot tube tow rope is rated at 6,000 pounds tensile strength! It's the strongest tube rope your money can buy, and is engineered to pull 5 or more riders.

Description	Part No.
6000 lb Tube Rope	AHTR-6000



WAKEBOARD ROPE

This wakeboard rope has a head turning 15 in. "Squid" patterned EVA grip wrapped around a floating aluminum core. The 5/16 inch, 16 strand, UV treated low stretch rope has 3 sections for wakeboarding at 45, 55 or 65 feet. Full length finger guards help create a comfortable split finger grip. A Rope Keeper is included for tangle-free storage.

Description	Part No.
Wakeboard Rope	AHWR-3



20' TOW ROPE

This 20 ft. tow rope has a heavy-duty carabiner at each end. The 12" long "soft hook" doubles as a rope wrap for neat storage. The 3/8" diameter rope is purple/yellow/red.

Description	Part No.
20' Tow-Rope	TR-20



WATER TOY TOW ROPE

This top quality 16 strand, 3/8" tow rope is 50 feet long.

Description	Part No.
Water Toy Tow Rope	WTR-50



AIRHEAD LINE WINDER

No more tangled lines with this classic styled floating line winder! It's easy to wind and neatly stow away anchor lines, mooring lines, ski ropes and tube ropes. Get a few for the garage too. Organize your extension cords, wires, clotheslines and Christmas lights once and for all. It's constructed of high impact polypropylene for extra long service. Color: Red. Ropes not included.

Description	Part No.
Airhead Rope Winder	AHLW-1

AIRHEAD® KWIK-CONNECT™

Conveniently attach and detach tube tow ropes to towables with AIRHEAD's KWIK-CONNECT. There's no need to thread 60 feet of rope through the tow strap each time you connect or disconnect a tow rope. The high impact KWIK-CONNECT has a 1 inch diameter hole to accept up to 6,000 lb. break strength tube ropes. Recommended for 1 to 4 rider towables that are not equipped with Kwik-Connects.



Description	Part No.
Kwik-Connect	AHKC-1



AIRHEAD HEAVY DUTY TOW HARNESS

This heavy duty tow harness is perfect for pulling skiers, wake boarders and up to 4 rider towables. Simply clip it onto your boat with the 5,000-pound tensile strength hooks, and attach your ski or tube rope to the heavy duty Kwik-Connect. A 6" float keeps the Kwik-Connect floating on top, away from your propeller. 12 feet long to fit larger boats and pontoons. Yellow / Red.

Description	Part No.
Airhead Tow Harness	AHTH-2

FOUR STROKE	INTAKE SYSTEMS	ENGINE/GASKETS	EXHAUST	DRIVE LINE HANDLING	ELECTRICAL	WATERLINE /BILGE	STEERING & CONTROLS	BODY	ACCESSORIES /SERVICE TOOLS/HARDWARE	CHEMICAL
-------------	----------------	----------------	---------	---------------------	------------	------------------	---------------------	------	-------------------------------------	----------

FOUR
STROKEINTAKE
SYSTEMSENGINE/
GASKETS

EXHAUST

DRIVE LINE
HANDLING

ELECTRICAL

WATERLINE
/BILGESTEERING
& CONTROLS

BODY

SERVICE TOOLS
ACCESSORIES
/HARDWARE

CHEMICAL



STIK-A-FLAG™ SKIER DOWN FLAG

The bright orange 420 denier nylon skier down flag is mounted to a 24" flag. PWC's with Kwik Tek's giant 3-1/4" suction cup. Required in AZ, CA, CO, ID, MO, NE, NM, OR, TX, UT & WA. Recommended everywhere for safety.

Description	Part No.
Skier Down Flag	SAF-1



IMPELLER PROTECTOR & KICK-BACK PROTECTOR

Specially designed for use on a personal watercraft, this Jet Logic protector reduces the possibility of the tow/ski rope of being sucked up inside the PWC's pump and impeller. This protector also protects PWC passengers from tow/ski rope kicking back when the rider falls.

Description	Part No.
24" long for PWC	IP-24



TRANSOM MOUNT SKI TOW HOOK

Our transom-mount ski tow is made from highly polished 304 stainless steel. A full stainless steel back plate distributes pressure evenly to prevent gel coat crazing. Tows are supplied with stainless steel nuts and star lock washers.

Description	Part No.
3/8" stock, 2-1/2" diam 4" legs, 2-1/2" transom	59-3437

AIRHEAD® 120 VOLT HI-PRESSURE AIR PUMP

You'll enjoy the performance of this 120 volt air pump. It inflates and deflates quickly and effectively. Peak pressure is 2.5 psi, plenty of pressure to get high end inflatable boats, rafts and reinforced backyard items nice and firm. You'll immediately notice how they perform better when properly inflated. A Pressure Release Valve is included to limit pressure to 1.4 psi for preventing over-inflating towables, pool toys and other vinyl and nylon covered inflatable items. The accordion-style hose locks onto the pump, eliminating annoying disconnections. Four universal valve fittings fit all popular valves and lock onto the hose. You'll love the screw-on Boston Valve adapter, an AIRHEAD exclusive. For added convenience, there's a carry handle and a 10 ft. long power cord. Draws 6.1 amps / 730 watts. Volume is 460 liters/minute.



Description	Part No.
Airhead Air Pump, 12 V	AHP-120HP

AIRHEAD® AIR PUMP, 12V

This high-volume (290 liters / minute) 12-volt portable air pump deflates towables, boats, pools, mattresses and beach toys quickly and effectively. Most pumps on the market, even those costing twice as much, don't put out this kind of air pressure and volume (9.6 cu.ft/min., .8 psi). The universal valve fittings fit all popular valves. For added convenience, the cigarette lighter plug is equipped with a 10 ft. long power cord.



Description	Part No.
Airhead Air Pump, 12 V	AHP-12H

AIRHEAD® DOUBLE ACTION PUMP

Perfect For Topping off Towables

This pump delivers a continuous stream of air on both the up and down strokes. It quickly inflates and deflates tubes, airbeds, boats, toys and other inflatables. Four universal valve fittings are included. The accordion-style hose stretches to 5 ft. long and interlocks to the pump, so that it doesn't fall off while you're pumping. Capacity is approximately 68 gallons / 60 strokes. Especially great for topping off towables, since peak pressure is 14 psi.



Description	Part No.
Airhead Double Action Pump	AHP-1

AIR DADDY™

AIR DADDY lets you get to the fun times more quickly! It allows you to inflate towables, swim toys, beach toys, inflatable boats, rafts, airbeds and sport balls with an air compressor at home or at a gas station. AIR DADDY is a universal adapter tapered to fit all valves found on inflatables, including all sizes of stem valves and Boston valves, Halkey-Roberts and Leaffield valves. The screw-on tip creates a high-pressure stream of air, perfect for workshops and garages. Soccer ball or football low on air? Stop by a gas station and use AIR DADDY's needle valve! Both the needle valve and high-pressure tip stow securely in the handle.



Description	Part No.
Air Daddy	AHAD-1

MULTI-VALVE

Inflate with Speed & Flexibility

The Airhead Multi-Valve consists of 2 Boston Valves with different thread patterns on the bottom of the Shrader Valve. One of the Boston Valves will fit your inflatable. Use the Shrader Valve to inflate quickly at a gas station or marina. Or, screw off the Shrader Valve and inflate the Boston Valve with a low pressure/high volume pump.



Description	Part No.
Multi-Valve	AHMV-1

AIRHEAD®

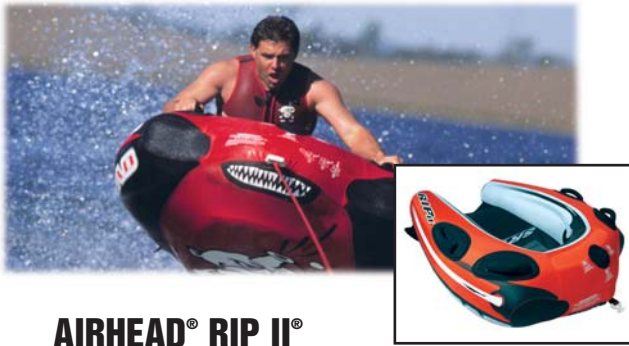

AIRHEAD® RIP II®

Carve turns with a tube? You can with RIP III. Simply lean in the direction you want to turn and pull on the opposite handle. The plastic fins sewn onto the side of the cover do the carving. RIP II is so much fun that you'll want to ride it all day long! You just might be able to, it's so easy to re-board with the open back design, and a feature that little ones and tired adults really appreciate. RIP II is fully covered with rugged 840-denier double-stitched nylon cover, making it torsionally rigid to respond to the rider's commands.

Description	Valve	Part No.
Airhead Rip II 1 rider	Multi-Valve	AHRI-2



AIRHEAD® BLAST®

You'll have a real blast on Airhead Blast! The 4 neoprene knuckle guards and deluxe nylon-covered handles provide a sure and comfortable grip. The heavy-duty virgin PVC bladder has a double stitched nylon cover, reinforced internal tow harness and a self-draining floor vent. You'll love the eye-catching graphics on this 1 rider 54" round towable!

Description	Valve	Part No.
Airhead Blast 1 rider	Boston Valve	AHBL-1



AIRHEAD® SURF™

Face it, stowing a tube on small boats, ski boats, and PWC's can be a hassle! We designed Surf with this watercraft in mind. Despite its small size, 50" x 40" x 6", Surf is big on performance. Sit on top or lie down, either way; you'll love the remarkably stable ride. Four deluxe handles with neoprene knuckle guards provide a great grip. SURF is equipped with a Boston Valve for fast inflating and deflating, 2 board straps and a drain vent.

Description	Valve	Part No.
Airhead Surf 1 rider	Boston Valve	AHSU-1



IMPROVED

Tapered Profile



AIRHEAD® BIG SLICE®

You'll really slice up the water with this 60" diameter low profile towable! Peak performance is guaranteed with Slice's topside neoprene knuckle guards, an Airhead exclusive. The durable 30-gauge virgin PVC bladder is fully encased by a double-stitched nylon cover with a reinforced internal tow harness. Slice is equipped with a super-convenient Kwik-Connect for easy hook-ups and a Boston Valve for fast inflating and deflating. It's easy to climb onto Slice from the water; it's tapered to only 6 in. high at the back. Designed for 1 or 2 riders.

Description	Valve	Part No.
Airhead Slice 1 or 2 riders	Boston Valve	AHSL-4

FOUR
STROKE

INTAKE
SYSTEMS

ENGINE/
GASKETS

EXHAUST

DRIVE LINE
HANDLING

ELECTRICAL

WATERLINE
/BLIGE

STEERING
& CONTROLS

BODY

ACCESSORIES

SERVICE TOOLS
/HARDWARE

CHEMICAL

AIRHEAD®



AHMX-V2



AHMX-V3

AIRHEAD® MATRIX™ V-2 & V-3

Wow! The thrill rides of the century have arrived! If you want real heart stopping tubing action unlike anything you've experienced before, think Matrix. No expense was spared in Matrix's state-of-the-art construction. The durable RF welded virgin vinyl PVC bladder is completely wrapped in double-stitched 840-denier nylon. A heavy-duty Kwik-Connect provides easy hook-ups and the Airhead Multi-Valve provides the ultimate in inflation and deflation convenience. Join the matrix tubing revolution now! Patent pending.

Description			Valve	Part No.
Airhead Matrix	2 riders	80" x 64"	Multi-Valve	AHMX-V2
Airhead Matrix	3 riders	97" x 74"	Multi-Valve	AHMX-V3



AIRHEAD® G-FORCE™



G-Force is a wild ride for up to 3 thrill-seekers! Defy centrifugal force with G-Force's topside stabilizers fins. The 6 deluxe nylon-wrapped handles with neoprene knuckle guards provide a sure and comfortable grip. G-Force has a tough 30-gauge virgin PVC bladder, fully covered with as 840-denier double-stitched nylon cover. G-Force is 72" x 62" and is equipped with a heavy-duty Kwik-Connect for easy and secure hook-ups. An Airhead Boston valve provides the ultimate in inflation and deflation convenience.

Description			Valve	Part No.
Airhead G-Force	3 riders	72" x 62"	Boston-Valve	AHGF-1



SPACE SHUTTLE MTC™

Doubles as a trailer!

MTC stands for Multi Towing Craft. This humongous and incredibly inflatable has a dual personality! Shuttle your coolers, beach chairs, skis, wake boards, gas cans, and other gear to your favorite beach inside Space Shuttle MTC, while you enjoy a comfortable boat or personal watercraft ride with your friends. Once you unload your gear onto the beach, you'll have the most exhilarating tube ride of your lives with plenty of room to stretch out. Space Shuttle MTC is 80" by 80" (deflated size) with 19" sidewalls. The rugged 30-gauge vinyl tube has an inflatable cushioned floor that drains to keep you and gear dry. The 840-denier double-coated nylon cover has a rear mesh drain vent and a double-reinforced towing harness. A cargo net is included to secure your gear. Eight deluxe handles with neoprene knuckle guards ensure a confident hold for up to four passengers.

Description			Valve	Part No.
Space Shuttle MTC	4 riders	80" x 80" x 19"	Boston-Valve	SS-1



AIRHEAD® HOT SHOT™

Come on hot shot, show us what you've got! If you like air time, you won't be disappointed! HOT SHOT, AIRHEAD's 57 in. (deflated) round deck tube is one hot ride, built to last and a great value. The rugged PVC bladder is completely covered with a double-stitched nylon cover. The thin profile makes it easy to climb onto from the water. HOT SHOT has 4 deluxe handles with neoprene knuckle guards and is equipped with a Boston valve for quick inflating and deflating.



Description	Valve	Part No.
Airhead Hot Shot	Boston-Valve	AHHS-1



AIRHEAD® U-TUBE™

U-TUBE is an innovative 1-2 rider towable with 2 different tow points. Pull it from the end and it rocks side to side, adding a new dimension to your tubing excitement. Pull it from the bottom and 2 can rider chariot style! Two oversized neoprene panels provide comfort. Six deluxe handles with neoprene knuckle guards give you lots of gripping options. The durable 30 gauge PVC bladder is fully covered by rugged 840 denier nylon. Dimensions: 61 in. x 60 in. (deflated).

Description	Valve	Part No.
Airhead U-Tube	Boston-Valve	AHUT-1



AIRHEAD® STING RAY™

Look out, AIRHEAD's STING RAYs are coming to get you! STING RAY graphics are real head turners. There are 3 models of STING RAY for 1, 2 and 3 riders. You'll love the lively performance that the winged design delivers. STING RAYs cross the wake effortlessly, yet they are very stable. The oversized backrests make these recumbent towables popular for all ages. There's a topside neoprene seat pad for each rider. Nylon wrapped handles with neoprene knuckle guards ensure a great grip. The durable RF welded 30 gauge PVC bladder is fully covered by rugged double-stitched 840 denier nylon. The tow harnesses and drain vents have been specially engineered to provide long service life. AHSTR-2: 2 rider, 88 in. x 73 in. (deflated)



Description	Valve	Part No.
Airhead Sting Ray	Boston-Valve	AHSTR-2

FOUR STROKE	INTAKE SYSTEMS	ENGINE/ GASKETS	EXHAUST	DRIVE LINE HARDWARE	ELECTRICAL	WATERLINE /RIGGE	STEERING & CONTROLS	BODY	ACCESSORIES	SERVICE TOOLS /HARDWARE	CHEMICAL
----------------	-------------------	--------------------	---------	------------------------	------------	---------------------	------------------------	------	-------------	----------------------------	----------

AIRHEAD® PERFORMANCE TRAVEL KAYAKS™

Inflatable kayaks are perfect for camping, vacationing, exploring remote areas, and for cruising yachts. They're also great for paddling enthusiasts that don't want to drive around with a kayak on their rooftop! AIRHEAD Travel Kayaks fit easily into the trunk of your car, duffel bag or suitcase. When you feel the itch to paddle, your boat is with you!



NEW

AIRHEAD® Performance Travel Kayaks Features:

- NMMA Approved
- Lightweight / compact / portable
- Highly visible orange for safety
- All 3 air chambers are completely enclosed by rugged 840-denier nylon with UV and water-resistant coatings
- Neoprene elbow guards for comfort
- Easy to inflate and deflate (3 Boston valves with nylon covers)
- D-rings at bow and stern for securing gear, Stretch net in bow
- Grab handles for easy put-ins and pull-outs
- Designed for lakes and moderate white water
- Inflatable seats with adjustable support backrest and mesh pocket
- Low drag / superior tracking with 4 bottom fins
- Durable tri-laminate bottom for a lifetime of use
- Adjustable foot brace
- Padded Shoulder Carrier Included
- Stainless steel and nylon hardware will not corrode
- Low drag, superior tracking
- Threaded drain plug

Description	Valve	Part No.
Airhead Performance Travel Kayak	Boston-Valve	AHTK-2



NEW

AIRHEAD® COOL ISLAND™

Hang out on AIRHEAD's COOL ISLAND and have a party! Sunbathe on the roomy sundeck, then cool off splashing around in the mesh area. Four drink holders and a sundry holder, perfect for storing suntan lotion, are conveniently located between the wet and dry areas. The boarding platform makes it easy to climb on top from deep water. There are 3 handles welded to the sides for carrying. Two tie down points are strategically welded to the sides for anchoring. Designed for up to 6 adults. Dimensions: 107 in. x 88 in. (deflated).

Description	Valve	Part No.
Airhead Cool Island	Speed-Valve	AHCI-1

AZ-18 AQUA ZOOKA™

Soak your friends with AQUA ZOOKA! This easy to operate, quick filling bazooka is constructed of high-impact thermoplastics and will last for seasons of fun. Simply dip AQUA ZOOKA into the water and pull back on the handle to siphon water up into the barrel. You're ready to fire, with a range of up to 60 feet! AQUA ZOOKA's are equipped with comfortable EVA handles so that you won't lose your grip, even with wet hands in the heat of battle! The EVA handles also ensure that AQUA ZOOKA will float on top of the water. Doubles as a bilge pump!



Description	Part No.
AQUA ZOOKA 18"	AZ-18



SUPER MABLE



SUPER MABLE



BIG MABLE

Description

Big Mable	69" (L) x 70" (W)
2 riders	175 cm (L) x 175 cm (W)
Super Mable	82" (L) x 83" (W)
3 riders	205 cm (L) x 210 cm (W)

Valve

Speed Safety Valve
Speed Safety Valve

Part No.

S53-2210
S53-2220

MEGA BOWL



Description

Mega Bowl	68" (L) x 58" (W) x 26 (H)
	170 cm (L) x 145 cm (W) x 65 cm (H)

Valve

Speed Safety Valve

Part No.

S53-1840



HALF-PIPE



SUMO TUBE

Description

Half-pipe Frantic	210" Dia (150cm)	Speed Safety Valve	S53-2160
3 rider			

Valve

Speed Safety Valve

Part No.

S53-2160



TEST PILOT



Description

Test Pilot Chariot	48" Dia (120 cm)
--------------------	------------------

Part No.

S53-1710

Description

Sumo Tube 1 rider	38"L x 33" Dia
-------------------	----------------

Valve

Speed Safety Valve

Part No.

S53-1805

FOUR STROKE	INTAKE SYSTEMS	ENGINE/GASKETS	EXHAUST	DRIVE LINE HANDLING	ELECTRICAL	WATERLINE /BLIGE	STEERING & CONTROLS	BODY	ACCESSORIES	SERVICE TOOLS /HARDWARE	CHEMICAL
-------------	----------------	----------------	---------	---------------------	------------	------------------	---------------------	------	-------------	-------------------------	----------

FACTORY ZERO

Factory Zero a Japanese based company specializing in the marine manufacturing industry first introduced the Factory Zero Jet Launcher in 1992. The original Jet Launcher was distributed primarily in Japan during the first years of production. The Jet Launcher has been upgraded and modified throughout the years based on all of the input and recommendations by the users and racers. The current Jet Launcher uses the highest quality materials available and easily assembles without any tools required.

In 2006 Factory Zero signed Hot Products as the exclusive USA importer and Worldwide PWC Distributor to supply the PWC Dealers of the world the best PWC Totes and Launchers available in the market.



J-130S

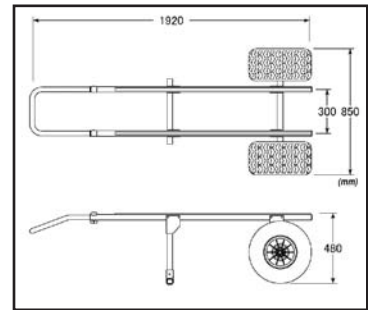

Description
Compact 2-Wheel Tote Stand-Up

Part No.
J-130S

BOX: H1530xW85xD60mm / 4kg, H535xW350xD95mm / 7kg
TIRE: H475xW475xD510mm / 12kg

FACTORY ZERO JET LAUNCHER - THE RACERS CHOICE WORLDWIDE



2007 CORONA EUROPEAN
JET SKI CHAMPIONSHIP
MURCIA, SPAIN



2007 CORONA EUROPEAN
JET SKI CHAMPIONSHIP
ZANDVOORT, NETHERLANDS



2007 IJSBA
WORLD FINALS
LAKE HAVASU CITY, AZ • USA

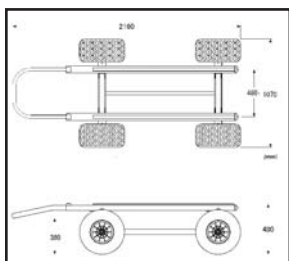

4-WHEEL TOTE 3 SEAT PWC

Extra strong and durable design with bolts and nuts assembly. This model is designed for the large 3 seat watercraft. Just load PWC onto tote and push across any and all surfaces.

BOX: H1635xW260xD170mm/ 12.5kg, H640xW530xD90mm / 1.4kg
TIRE: H475xW475xD510mm / 12kg x 2



J-1480-4

Description
4-Wheel Tote 3 Seat PWC

Part No.
J-1480-4

**Due to the size of this product it is not covered by the Hot Products shipping policy*

FACTORY ZERO



J-1300

2-WHEEL TOTE STAND UP/SPORT CLASS

Extra strong and durable design with bolts and nuts assembly. This model is designed for Stand-up and Sport class watercraft. A special designed leverage function frame allows you easy launching and loading of watercraft, all by yourself.

BOX: H1635xW435xD165mm / 11.5kg TIRE: H475xW475xD510mm / 12kg

Description	Part No.
2-Wheel Tote Stand-Up/Sport Class	J-1300

**Due to the size of this product it is not covered by the Hot Products shipping policy*



FACTORY ZERO JET BANK

This Factory Zero model is designed to hold 2 and 3 seat Personal Watercraft. The front two wheels allow for the user to steer the watercraft into the tightest of ares without any issues. Great for showrooms, repair shops, or marine storage facilities.

BOX: H1635xW260xD170mm / 14.5kg H790xW390xD200mm / 5.7kg
 TIRE: H475xW475xD510mm / 12kg H450xW450xD210mm / 12kg
 BAR: H2690xW80xD80mm / 6.9kg

Description	Part No.
Factory Zero Jet Bank	J-2260LS

**Due to the size of this product it is not covered by the Hot Products shipping policy*

JET LAUNCHER (J-130S) REPAIR PARTS

Factory Zero offers one of the highest quality Jet Launchers for your Stand-up PWC and has repair/replacement parts available to allow you to utilize your Jet Launcher to a use for many years.

Description	Part No.
Composite Fiber Washer	Z7000
Needle Only (10psi)	Z7001
Bearing Cage Only	Z7002
Nylon Cap	Z7003
Nylon Washer	Z7004
"D" Ring	Z521
Bearing Complete Set	Z7007
1. Plastic Washer for Jet Launcher J-130S	Z6037
2. Plastic Knob for Jet Launcher J-130S	0S0015
3. "R" Pin For Legs of Jet Launcher J-130S	P13-130
4. Stainless Hook for Jet Launcher J-130S	JL100
5. Pin MS-55 for Legs of Jet Launcher J-130S	P-17-16

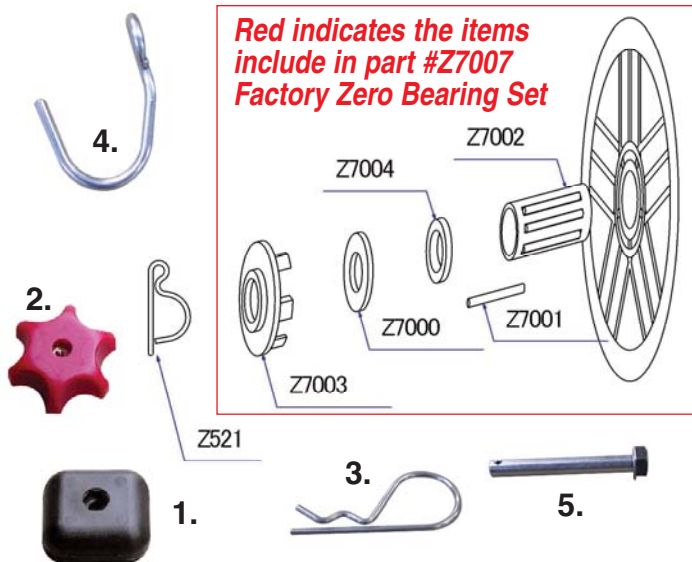

AC RACING BEACH STAND

Thick wall tubing and heavy gauge angle aluminum construction. Excellent durability. Not designed for use out of water.

Description	Part No.
2 Seater Personal Watercraft	59-4005*
Stand-Up Personal Watercraft	59-4000*

**Due to the size of this product it is not covered by the Hot Products shipping policy*



Sit-down model shown



AC RACING PWC SHOP/WORK STAND

- 5" swiveling caster wheels
- Aluminum box tubing
- Gray carpeted 2 x 4's

Not designed for use in water!

Description	Part No.
High Profile for Stand-up Personal Watercraft	03-0500*
Low Profile for Sit-down Personal Watercraft	03-0600*

**Due to the size of this product it is not covered by the Hot Products shipping policy*

FOUR STROKE	INTAKE SYSTEMS	ENGINE/GASKETS	EXHAUST	DRIVE LINE HANDLING	ELECTRICAL	WATERLINE /BILGE	STEERING & CONTROLS	BODY	ACCESSORIES	SERVICE TOOLS /HARDWARE	CHEMICAL
-------------	----------------	----------------	---------	---------------------	------------	------------------	---------------------	------	-------------	-------------------------	----------

FOUR
STROKEINTAKE
SYSTEMSENGINE/
GASKETS

EXHAUST

DRIVE LINE
HANDLING

ELECTRICAL

WATERLINE
/BILGESTEERING
& CONTROLS

BODY

ACCESSORIES

SERVICE TOOLS
/HARDWARE

CHEMICAL



FILLER HOSE

Upgrade your Scribner (VP Fuel) Jugs with a filler hose to make refueling your PWC easier and make spills a thing of the past.

**Designed for use with Scribner Utility Jugs, not compatible with Hunsacker*

Description	Part No.
Filler Hose Kit w/Screw Cap	59-3456



CARBON TECH FUEL TAGS

Can't remember if you put oil in the gas? Get one of these fuel tags. These plastic tags state "unmixed" on one side and "mixed" on the other side.

Description	Part No.
Carbon Tech Fuel Tag	FT1



BILLET JUG BREATHER

Fits most 5-gallon utility jugs. Simple one touch operation. Pull to open, push down to shut off.

**Designed for use with Scribner Utility Jugs, not compatible with Hunsacker Utility Jugs.*

Description	Part No.
Blue	02-001
Red	02-002
Silver	02-003



DAS PUMP FINGER TIP PUMP

Simple finger tip pump that removes water from your engine compartment and siphons gas. Includes length of hose to reach the depths of your engine compartment or gas tank.

Gets into the tightest places and is easy to use. Prevents corrosion and rusting to your engine due to condensation. "Das Pump"

Description	Part No.
DAS Pump	57-4045



DELUXE SIPHON PUMP

Deluxe Siphon Pump made with a heavy duty marine grades siphon bulb and gas resistant hose. This is the easy way to get a siphon started to drain your bilge or to transfer fuel from one place to another.

Description	Part No.
Deluxe Siphon Pump	59-0440



RATIO RITE CUP & LID

The Ratio Rite measuring cup is specifically designed to help you premix gasoline for your two stroke engine.

16:1 to 70:1 mix ratios are molded into this cup, measure your two cycle oil in cc/milliliters, fluid ounces, and pints. Made from durable, long lasting plastic that is completely safe to use with fuel and oil. *Ratio Rite lid sold separately

Description	Part No.
Ratio Rite Cup	59-0548
Ratio Rite Lid	59-0582



LISLE CREEPER SEAT/STEP

Ergonomic design with a 300lb. capacity that can be rotated forward onto rubber feet to make a stable 14" tall ladder. Spacious storage tray below the seat keeps tools, test equipment and parts within easy reach. Perfect for PWC service, PWC pump repairs, etc. Wheels pop into tubular steel legs with an outrigger design for added stability.

Description	Part No.
Lisle Creeper Seat/Step	LS93402



SCEPTER FLEXIBLE FUNNEL

Scepter's flexible funnel is perfect for all your PWC uses and really helps perform those difficult maintenance and repair applications. Manufactured from quality, high density polymers: the funnel won't rust, dent, or crack. This means no drips and leaks for you to clean up after your done. The funnel length is 18".

Description	Part No.
Scepter 18" Flexible Funnel	MR03603



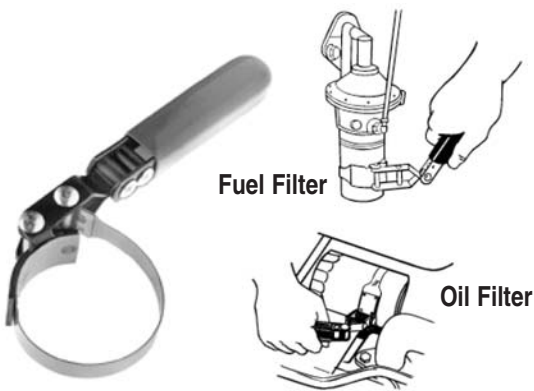

Fuel Filter

Oil Filter

"SWIVEL GRIP" OIL / FUEL FILTER WRENCH

For Smaller 2 3/8" to 2 5/8" Oil Filters. Also fits Fuel Filters. For small oil and fuel filters. Tough stainless steel band with special "teeth" for extra gripping power...won't slip. Special narrow 1/2" band fits in tight spots. Handle swivels to clear obstructions and makes it easy to turn in hard to reach locations. Vinyl covered handle. Covers a range of 2 3/8" to 2 5/8" (60.3 - 66.7mm)

Description	Part No.
"Swivel Grip" Oil / Fuel Filter Wrench	LS54400



4.5 GALLON DRAIN PANS

Now with built-in-ribs for draining filters in the pan. For easy transfer of liquids. High-density polyethylene material is resistant to chemicals and solvents, and is easy to clean. 1" wide diameter spout for quick and easy pouring. The anti-splash lip and baffles help prevent spilling when carrying or pouring. Comes with large, easy-grip handles. Two colors: 17942 is black for oil and 17952 is green for anti-freeze.

Description	Part No.
4.5 Gallon Oil Drain Pan, Black	LS17942
4.5 Gallon Oil Drain Pan, Green	LS17952

MOELLER MARINE PRODUCTS FLUID EXTRACTOR

- Empties oil in 15 pumps or less
- Extracts warm or cold oil
- Pressure relief valve allows easy transportation and storage
- Single-hand-ease effortless operation
- Tethered cap
- Delivers gulp-free, mess-free performance
- Complete adapter kit is included featuring three extraction tubes

Description	Part No.
Moeller Fluid Extractor (6.5 Liter Fluid Extractor)	MR07398
Moeller Fluid Extractor Tube Replacement Kit	MR08032

*Note: Not for use with gasoline.

Complete Adapter Kit Included with MR07398



MR08032 Replacement Tubes

USA Patent #5450924 - Germany Patent #29500683.8 - U.K. Patent #2272948
Australia Patent #674469 - Taiwan Patent #113238 - China Patent #ZL92241981.7



RULE FLAT TANK ELECTRIC OIL EXTRACTOR

Eliminate those costly yard service fees with the new quick, clean, compact electric oil extractor. Includes a 3-1/2 gallon compact self-priming diaphragm pump for extraction and an easy pour spout for oil transfer.

- 3.5 gallon (13 liter) leak proof container
- Designed for ease of carrying
- Complete with dipstick, suction tube & battery clamps
- Empties and stows easily

- Self-priming, dry running, 12 or 24 volt diaphragm pump

Description	Part No.
Electric Oil Extractor	17860-0012



HYDRO-TURF OIL EXTRACTOR

The unit uses a small vacuum system, which pumps fluid through a hose to the 6-liter reservoir. It also includes a pour spout to aid in emptying the reservoir. Pump is removable for easy storage.

Description	Part No.
Hydro-Turf Oil Extractor	OIL01



Tethered Cap & Easy Pour Spout

Pressure Release Valve

No Overflows With Built-in Automatic Shut-off Float!

Durable Plastic Body

Patented Vacuum Pump Pulls Fluid 3x Faster!

Built-In Metal Foot-Ring

FOUR STROKE	ENGINE/ GASKETS	EXHAUST	DRIVE LINE HANDLING	ELECTRICAL	WATERLINE /BILGE	STEERING & CONTROLS	BODY	ACCESSORIES /HARDWARE	SERVICE TOOLS	CHEMICAL
-------------	-----------------	---------	---------------------	------------	------------------	---------------------	------	-----------------------	---------------	----------



SKEEKEEPER TIE DOWNS

Fits all PWC with 5/8" or 3/4" Bow Eyes.
Available in Single or Double Hook.

Description	Part No.
Single Hook	TS-60-BLK
Double Hook	TS-62-BLK



ANCRA WATERCRAFT TRAILER TIE DOWNS

Fits all PWC with 3/4" Bow Eyes.

Color	A. Double Hook Without Bow Eye Pin	B. Single Hook With Bow Eye Pin	C. Double Hook With Bow Eye Pin
	Purple	59-3404-PPL	59-3404-PPL-S
Pink	59-3404-PNK	59-3404-PNK-S	59-3404-PNK-D
Lime Green	59-3404-GRN	59-3404-GRN-S	



HOOK-IT TIE DOWN MOUNT

Patented hook retainer eliminates unhooking.
Provides a location to tie down your watercraft
where you want it.

Description	Part No.
Hook-It Tie Down Mount	TS-65



YAMAHA TIE DOWN PIN

The tie down pin can be used to which your
boat on your trailer, attach a docking line, attach
anchor, or tie down your Yamaha. Just drop the
pin in your front or rear bow eye.

Description	Part No.
Yamaha Tie Down Pin	59-3438



POWERTYE TIE DOWNS

Made from high quality 4500lb. test nylon strap
with rubber coated hooks. Made in USA

Description	Part No.
Black	59-3425
Navy Blue	59-3428
Silver	59-3429



SKEEKEEPER BOW PIN

Fits any PWC trailer with a 5/8" bow coupler.
Bow stop pictured is not included.

Description	Part No.
Bow Pin	TS67



SKEEKEEPER HITCH PIN

Fits any receiver-style hitch with a 2" insert.
*Trailer hitch receiver and ball pictured is
not included.*

Description	Part No.
Hitch Pin	TS68



R&D EZ-SLIDE BUNK GLIDES



R&D EZ-Slide Bunk Glides are designed to mount directly on the top side of the trailer bunks creating a new low friction slippery surface that allows the watercraft to glide on or off the trailer, making loading and unloading a personal watercraft easy. Designed and molded from high density urethane to significantly support the hull surface for proper trailering. The EZ-Slides are black and come in a six piece set complete with stainless steel button head mounting hardware. One set needed per watercraft.

Description	Part No.
EZ-Slide Bunk Glides (Set of 6)	001-00122

STOLTZ BOW STOPS AND SUPER ROLLERS

Stoltz polyurethane rollers and bow stops have non-marking assurance built-in and will not put any marks on your boat. No more hard work cleaning your boat. Made in USA.



PWC-5A

Bow Stop

For PWCs with a vertical hole. Fastens with "U" bolts. 3-1/2" Opening



PWC-9
2" Bow Stop

Fits 2" wide bracket for 1/2" shaft



Made in U.S.A.



RP-325
3" End Cap
For 1/2" shaft

Descriptions	Part No.
PWC Bow Stop	PWC-5A
PWC 2" Bow Stop	PWC-9
1/2" Shaft 3" End Cap	RP-325



RV TRAILER WIRING SOCKET ADAPTER

This adapter converts the large 7 prong RV style wiring plug to the standard universal flat 4 way trailer wiring. No cutting or splicing required.

Description	Part No.
RV Trailer Wiring Adapter	73012



Plastic



Metal

LICENSE PLATE BRACKETS

- Choice of either plastic or metal license plate brackets.
- 1/4" mounting holes on 2" centers.

Description	Part No.
Plastic License Plate Bracket	WB-3211
Metal License Plate Bracket, Plated	WB-3213



WATERPROOF IDENTIFICATION LIGHT BAR

- For vehicles 80" wide or wider.
- Waterproof lamp. Pre-wired w/60" leads.
- Dimensions: 14-1/4" x 1-1/8" x 1"

Description	Part No.
Waterproof Identification Light Bar	WB-003315



4-WAY CONNECTORS WITH ELECTRIC WIRE HARNESS

- Wesbar harnesses conform to all applicable SAE, NMMA & TMA standards.
- Standard 4-way harnesses have an 18" ground wire except where noted.

4-Way Harness	Part No.
18" Trailer Connector—Wunside	WB-007285
18" Trailer Connector—Wishbone	WB-007286
25' Trailer Harness—Wishbone	WB-007261
25' Trailer Harness Kit—Wishbone /Connector	WB-007103
30' Trailer Harness Kit—Wishbone /Connector	WB-007104



TRUNK CONNECTOR

4-Way female connector mates with most standard flat 4-way plugs

Description	Part No.
4' Trunk Connector	WB-7275
6' Trunk Connector	WB-7272



TRUNK/TRAILER CONNECTOR SET

Includes 48" trunk and 18" trailer 4-Way connector

Description	Part No.
Trunk/Trailer Connector	WB-7270



SUBMERSIBLE TAIL LIGHT

Widely used by jet ski and boat trailer manufacturers, these multi-function submersible tail lights are designed to protect the bulbs and contacts when the trailer is under water during launching and loading. They employ a "trapped air" technique to keep water from the bulbs. The bulbs and lenses are easily replaceable. Closed bottom design prevents splashing water and road grit from entering the lamp and meets all applicable DOT regulations. The lights come with pre-installed wire leads and two 1/4" mounting studs on 2" centers.

Description	Part No.
Lens, Tail Lamp	WB-403335
Lens, Side Marker, Red	WB-003337
Lens, Side Marker, Amber	WB-003338
7-Function Tail Lamp , Submersible (LH)	WB-3023
6-Function Tail Lamp , Submersible (RH)	WB-3073



SEALED 2.5" ROUND CLEARANCE/MARKER LAMP WITH REFLECTOR

Sonically sealed lamp with Reflex reflector. Amber.

Description	Part No.
Amber SM/Clearance	WB-3385

FOUR STROKE
INTAKE SYSTEMS
ENGINE/GASKETS
EXHAUST
DRIVE LINE HANDLING
ELECTRICAL
WATERLINE /BILGE
STEERING & CONTROLS
BODY
ACCESSORIES
SERVICE TOOLS /HARDWARE
CHEMICAL

FOUR
STROKEINTAKE
SYSTEMSENGINE/
GASKETS

EXHAUST

DRIVE LINE
HANDLING

ELECTRICAL

WATERLINE
/BILGESTEERING
& CONTROLS

BODY

ACCESSORIES

SERVICE TOOLS
/HARDWARE

CHEMICAL

VHF



ALESSANDER LENZI
VOL. 1 VIDEO
71-0009



ALESSANDER LENZI
VOL. 3 VIDEO
71-0008



ERIC "CYCLONE"
MALONE VIDEO
71-0005



COASTAL RAGE JET
ADDICTION VIDEO
71-0012



V JET WAVE CUP
2003 WORLD
CHAMPIONSHIP
71-0016



CAMPEONATO
BRASILEIRO
DE JET SKI 2004
71-0018

DVD



2004 LENZI DVD
71-0020

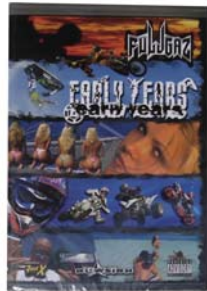

THE EARLY YEARS DVD
FLGZ1



THE ADDICTION
70-0030



TWANGULATION
DVD
70-0022

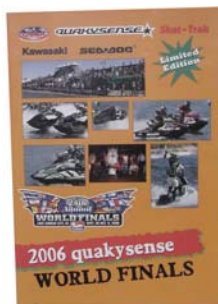

WORLD FINALS
2006
WFDVD2006



WORLD FINALS
2007
WFDVD2007



WORLD FINALS
2008
WFDVD2008

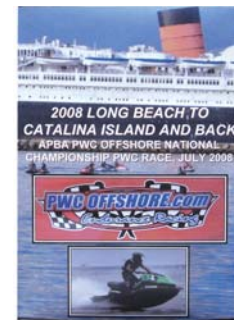

08 LONG BEACH TO
CATALINA DVD
OFFSH002



NATIONAL CHAMPION MIKE FOLLMER WATERCRAFT RACER MODEL KIT

This kit is a great fun model kit to assemble and then display for all your friends and family to see. Don't miss your chance to purchase this limited production model kit.

Description
Watercraft Racer Model Kit

Part No.
85-5030